

Scoil Iognaid Safe Routes to School 'School Zone' Concept May 2022
A 'talk through' of this drawing and online feedback form is available at www.galwaycity.ie/SRTS

LEGEND:

Existing Footpath

Existing Pavement

Footway - Concrete

Footway - Imprinted Concrete

Ramp

Pavement - Imprinted Asphalt

High Friction Surface - Buff

Cycleway

Tactile Paving - Buff

Tactile Paving - Red

Landscaping / Vegetation

Existing Kerb

Kerb - Full Height 125mm

Kerb - Drop Kerb

Kerb - Pedestrian 6mm

Kerb - Vehicular 25mm

Road Marking - Lines

Road Marking - Text

School Sign

Bollard - Pencil

Bollard - Rigid

Seating

Existing Belisha Beacon

Belisha Beacon

Existing Public Lighting

Public Lighting

Tree

Street Art

Rev	Date	Description	By	Chkd.
A	17/05/22	Issued for Public Consultation	KP	LG

Client:
 Comhairle Cathrach na Gaillimhe
Galway City Council

Project:
Safe Routes to School

Title:
Scoil Iognaid
Preliminary Design
Sheet 1 of 3

Prepared by:
L. Salameh

Checked:
L.Gaffney

Date:
May 2022

Project Director:
John O'Flaherty

Drawing Status:
Preliminary

Scale @ A1:
1:125 (A3@1:250)

Galway Office
Fairgreen House, Fairgreen Road,
Galway,
H91 AXK8,
Ireland.
Tel: +353 (0)91 565 211
www.tobin.ie

TOBIN
CONSULTING ENGINEERS

TOBIN Consulting Engineers will not be liable for any use of this document for any purpose other than that for which it was originally prepared and provided. Except where specifically and explicitly agreed in writing by TOBIN Consulting Engineers, as copyright holder, no part of this document may be reproduced or transmitted in any form and this document shall not be relied upon by any third party for any purpose.

Drawing No.: **11220-1031-01**

Revision: **A**

© Copyright Ordnance Survey Ireland. All rights reserved. Licence No. 2021/21/CCMA/Galway City Council

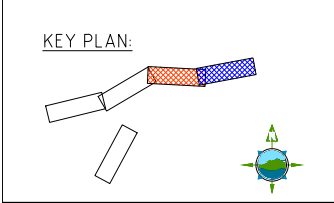
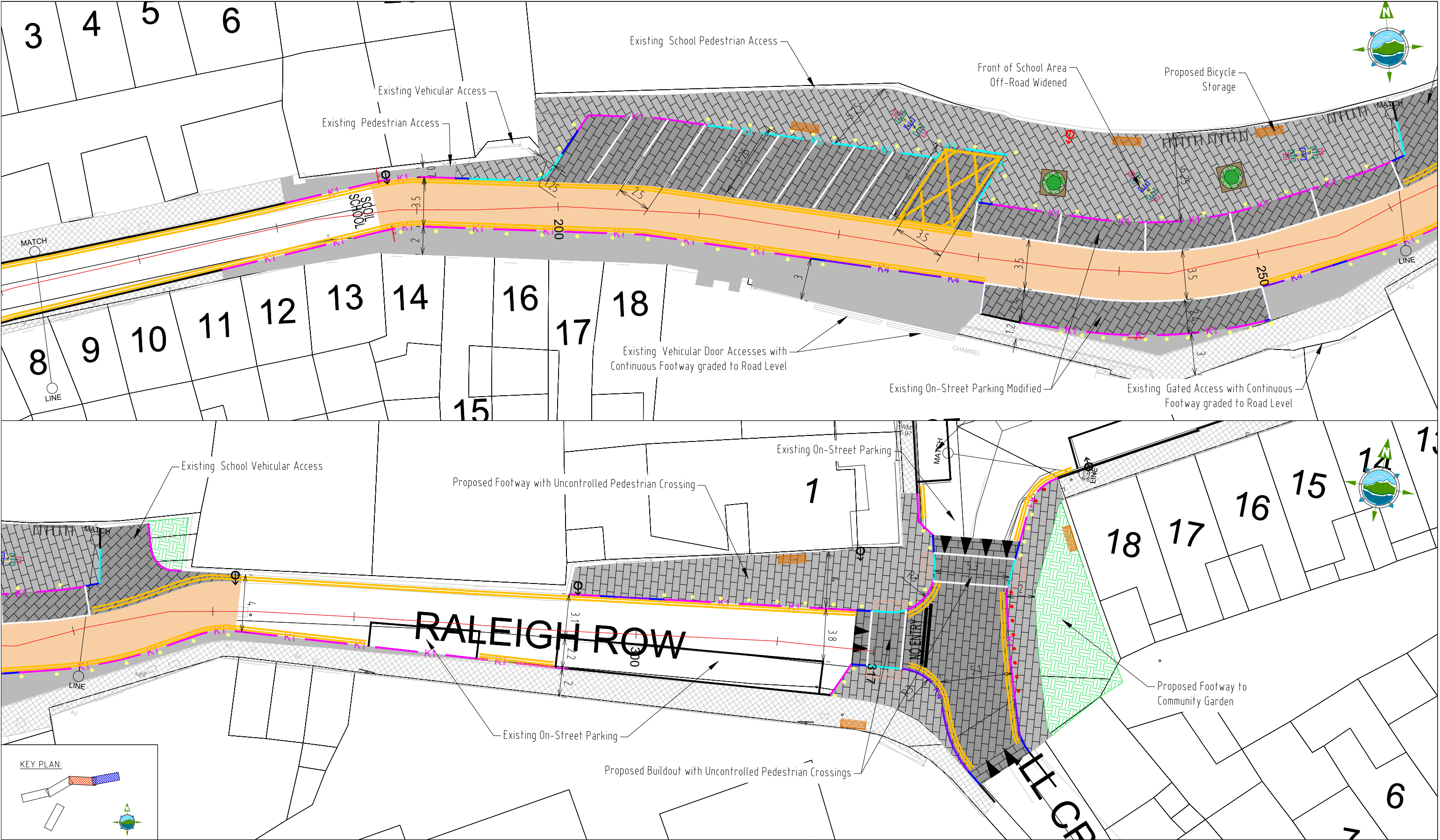

LEGEND:

	Existing Footpath		Existing Kerb		Existing Belisha Beacon
	Existing Pavement		Kerb - Full Height 125mm		Belisha Beacon
	Footway - Concrete		Kerb - Drop Kerb		Existing Public Lighting
	Footway - Imprinted Concrete		Kerb - Pedestrian 6mm		Public Lighting
	Ramp		Kerb - Vehicular 25mm		Tree
	Pavement - Imprinted Asphalt		Road Marking - Lines		Street Art
	High Friction Surface - Buff		Road Marking - Text		
	Cycleway		Road Sign		
	Tactile Paving - Buff		Bollard - Pencil		
	Tactile Paving - Red		Bollard - Rigid		
	Landscaping / Vegetation		Seating		

Rev	Date	Description	By	Chkd.
A	17/05/22	Issued for Public Consultation	KP	LG

Client: Comhairle Cathrach na Gaillimhe
Galway City Council

Project: **Safe Routes to School**

Title: **Scoil Iognáid
Preliminary Design
Sheet 2 of 3**

Prepared by: L. Salameh

Checked: L. Gaffney

Date: May 2022

Project Director: John O'Flaherty

Drawing Status: Preliminary

Scale @ A1: 1:125 (A3@1:250)

TOBIN
CONSULTING ENGINEERS

Galway Office
Fairgreen House, Fairgreen Road,
Galway,
H91 AXK8,
Ireland.
Tel: +353 (0)91 565 211
www.tobin.ie

Tobin Consulting Engineers will not be liable for any use of this document for any purpose other than that for which it was originally prepared and provided. Except where specifically and explicitly agreed in writing by Tobin Consulting Engineers, as copyright holder, no part of this document may be reproduced or transmitted in any form and this document shall not be relied upon by any third party for any purpose.

Drawing No.: **11220-1031-02**

Revision: **A**

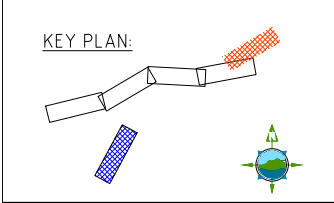
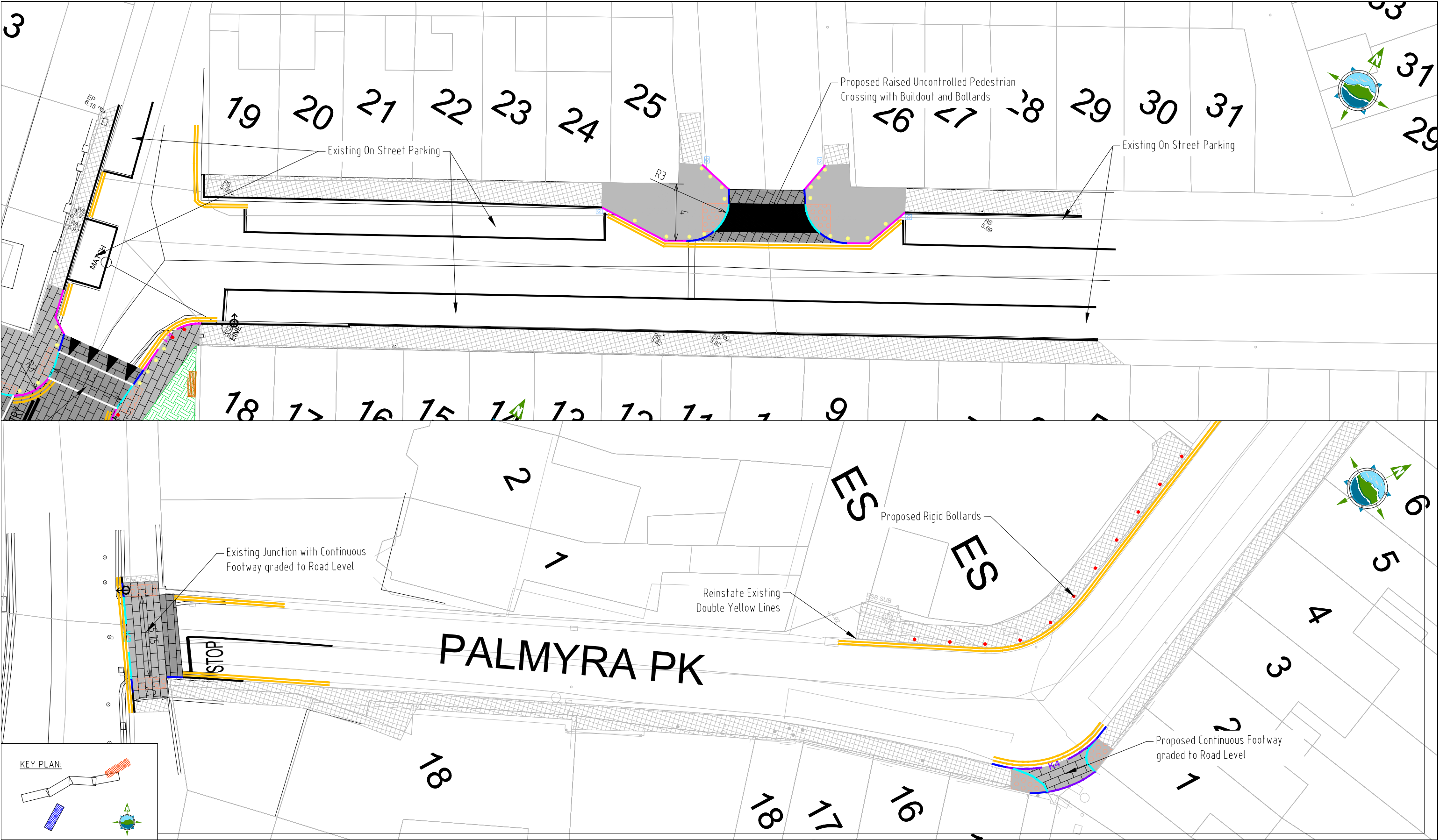

LEGEND:					
	Existing Footpath		Existing Kerb		Existing Belisha Beacon
	Existing Pavement		Kerb - Full Height 125mm		Belisha Beacon
	Footway - Concrete		Kerb - Drop Kerb		Existing Public Lighting
	Footway - Imprinted Concrete		Kerb - Pedestrian 6mm		Public Lighting
	Ramp		Kerb - Vehicular 25mm		Tree
	Pavement - Imprinted Asphalt		Road Marking - Lines		Street Art
	High Friction Surface - Buff		Road Marking - Text		
	Cycleway		Road Sign		
	Tactile Paving - Buff		Bollard - Pencil		
	Tactile Paving - Red		Bollard - Rigid		
	Landscaping / Vegetation		Seating		

Rev	Date	Description	By	Chkd.
A	17/05/22	Issued for Public Consultation	KP	LG

Client:
 Comhairle Cathrach na Gaillimhe
Galway City Council

Project:
Safe Routes to School

Title:
Scoil Iognáid
Preliminary Design
Sheet 3 of 3

Prepared by:
L. Salameh

Checked:
L. Gaffney

Date:
May 2022

Project Director:
John O'Flaherty

Drawing Status:
Preliminary

Scale @ A1:
1:125 (A3@1:250)

Galway Office
Fairgreen House, Fairgreen Road,
Galway,
H91 AXK8,
Ireland.
Tel: +353 (0)91 565 211
www.tobin.ie

TOBIN Consulting Engineers will not be liable for any use of this document for any purpose other than that for which it was originally prepared and provided. Except where specifically and explicitly agreed in writing by TOBIN Consulting Engineers, as copyright holder, no part of this document may be reproduced or transmitted in any form and this document shall not be relied upon by any third party for any purpose.

Drawing No.: **11220-1031-03**

Revision:
A